

BASE BID : FROM WINGWALL IN BALL FIELD TO JUNCTION CHAMBER 309 ON PARK AVENUE

ADD-ON 1: FROM NORTHERN CONNECTION TO JUNCTION CHAMBER 309 ON PARK AVENUE TO JUNCTION CHAMBER ON ARCADIA ROAD

ADD-ON 2: MH 353 ON PARK AVENUE TO MH 325 ON LOCKWOOD AVENUE

ADD-ON 3: MH 358 TO MH 328 ON HIGHVIEW AVENUE

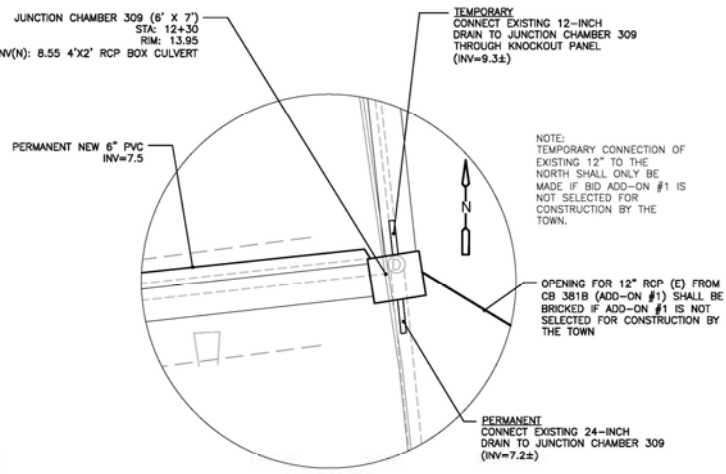
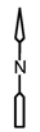
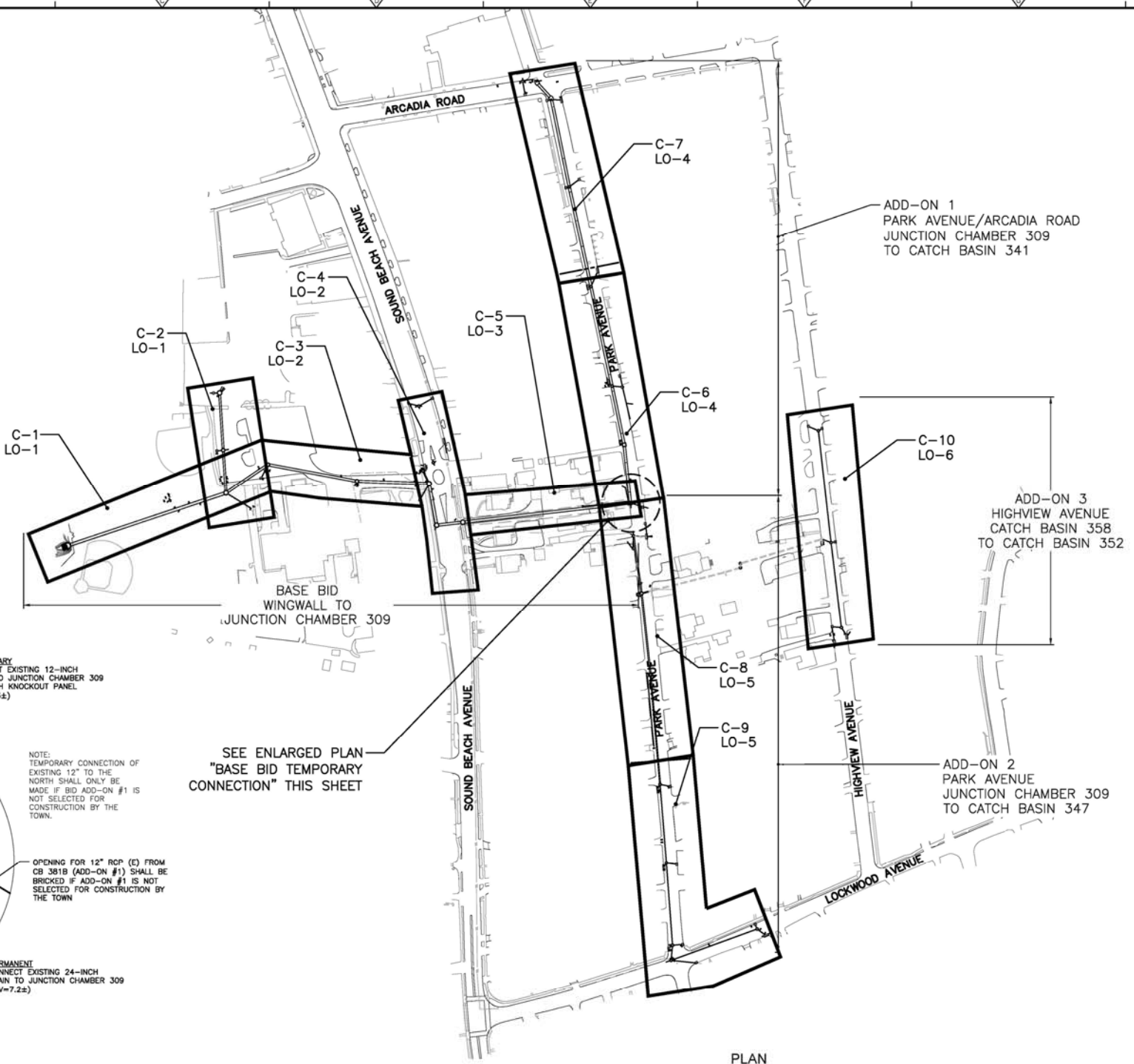

BASE BID TEMPORARY CONNECTION PLAN

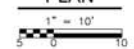

SEE ENLARGED PLAN "BASE BID TEMPORARY CONNECTION" THIS SHEET

PLAN  
1" = 100'

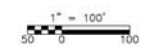

© 2017 CDM SMITH ALL RIGHTS RESERVED. THESE DOCUMENTS AND DESIGNS PROVIDED BY PROFESSIONAL SERVICE INCORPORATED HEREIN, ARE THE PROPERTY OF CDM SMITH AND ARE NOT TO BE USED, IN WHOLE OR PART, FOR ANY OTHER PROJECT WITHOUT THE WRITTEN AUTHORIZATION OF CDM SMITH.

REV. NO.	DATE	DRWN	CHKD	REMARKS

DESIGNED BY: E. COREY  
 DRAWN BY: J. CABRERA/S. ENGEL  
 SHEET CHK'D BY: P. MCKEOWN  
 CROSS CHK'D BY: G. FURBER  
 APPROVED BY: [Signature]  
 DATE: JANUARY 2017

**CDM Smith**

111 Founders Plaza  
 East Hartford, Connecticut  
 Tel: (860) 426-7610

TOWN OF GREENWICH, CONNECTICUT  
 OLD GREENWICH  
 STORM DRAIN IMPROVEMENTS  
 TOWN PROJECT NO. 14-31

GENERAL PLAN

PROJECT NO. 20449-108814  
 FILE NAME: G002NFP1  
 SHEET NO.  
**G-2**