

LEGEND - SIGNS & SYMBOLS

SIGN	DOT CATALOG NO.	SIGN	DOT CATALOG NO.
(A)	80-9928 (BLANK) VARIABLE LEGEND 60"x30"	(F)	80-9708 24"x18"
(B)	80-9877 60"x30"	(G)	80-9080 48"x30"
(C)	80-9916 48"x10" 80-9710 24"x30"	(H)	31-0557 48"
(D)	80-9916 48"x10" 80-9710 24"x30"	(I)	80-9916 48"x10" 80-9710 24"x30"
(E)	80-9916 48"x10" 80-9710 24"x30"	(J)	80-9916 48"x10" 80-9710 24"x30"
		(K)	80-9916 48"x10" 80-9710 24"x30"

NOTE

- ALL CONFLICTING SIGNS SHALL BE COVERED OR REMOVED.
- DETOUR SIGNS ARE ONLY TO BE POSTED WHEN DETOUR IS IN USE.
- DETOUR SIGNS SHOULD BE COVERED OR REMOVED WHEN DETOUR IS NOT IN USE.
- SIGN SUPPORTS SHALL BE TYPICAL METAL SIGN POSTS AS DETAILED ON CONN. DEPARTMENT OF TRANSPORTATION STANDARD SHEET NO. TR-1208_02.
- "ROAD CLOSED" AND "STOP" (31-0557) SIGNS SHALL BE DISPLAYED IN FRONT OF TYPE III BARRICADES.

- SIGN ON SINGLE POST
- SIGN ON DOUBLE POST
- PORTABLE SIGN SUPPORT
- BARRICADE WARNING LIGHT - HIGH INTENSITY
- TEMPORARY PRECAST CONCRETE BARRIER CURB

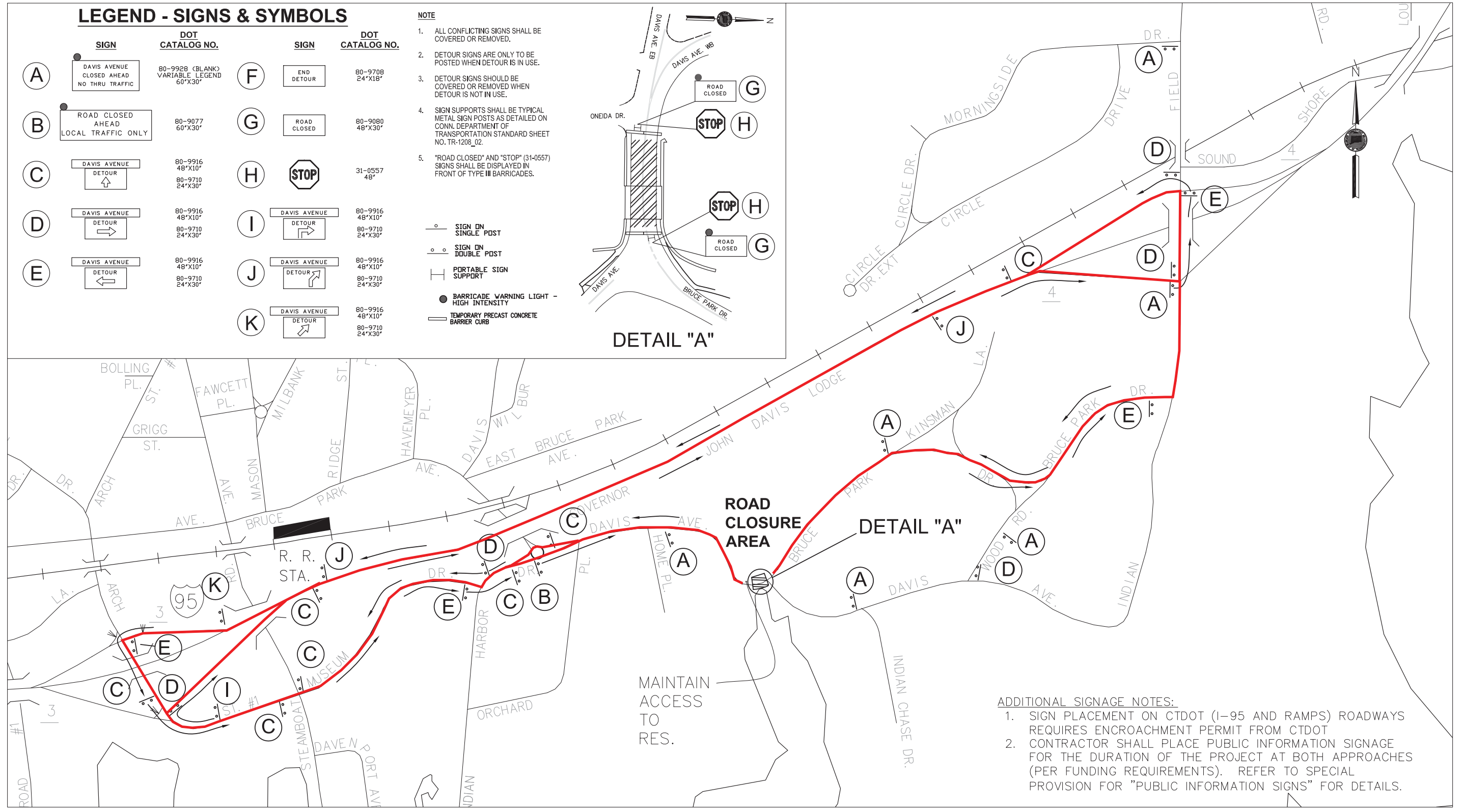
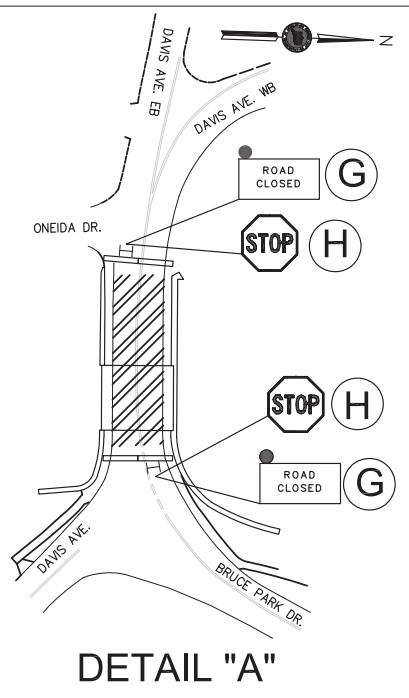

ADDITIONAL SIGNAGE NOTES:

- SIGN PLACEMENT ON CTDOT (I-95 AND RAMPS) ROADWAYS REQUIRES ENCROACHMENT PERMIT FROM CTDOT
- CONTRACTOR SHALL PLACE PUBLIC INFORMATION SIGNAGE FOR THE DURATION OF THE PROJECT AT BOTH APPROACHES (PER FUNDING REQUIREMENTS). REFER TO SPECIAL PROVISION FOR "PUBLIC INFORMATION SIGNS" FOR DETAILS.

DETOUR PLAN

<table border="1"> <thead> <tr> <th>REV.</th> <th>DATE</th> <th>DESCRIPTION</th> <th>SHEET NO.</th> </tr> </thead> <tbody> <tr> <td> </td> <td> </td> <td> </td> <td> </td> </tr> <tr> <td> </td> <td> </td> <td> </td> <td> </td> </tr> <tr> <td> </td> <td> </td> <td> </td> <td> </td> </tr> </tbody> </table>	REV.	DATE	DESCRIPTION	SHEET NO.													<p>MANUAL REVISIONS TO THIS DOCUMENT ARE PROHIBITED. ALL REVISIONS MUST BE DONE TO ELECTRONIC MEDIA.</p>	<p>CONSULTANT:</p>	<p>DESIGNER: M. HABEK</p> <p>DRAFTER: M. HABEK</p> <p>CHECKED BY: R. MEARS</p> <p>DATE CHECKED: 03/20/2020</p>	<p>TOWN OF GREENWICH DEPARTMENT OF PUBLIC WORKS</p>	<p>PROJECT TITLE:</p> <p>REPLACEMENT OF BRIDGE NO. 05012 DAVIS AVENUE OVER INDIAN HARBOR</p> <p>SCALE AS NOTED</p>	<p>TOWN:</p> <p>GREENWICH, CONNECTICUT</p> <p>DRAWING TITLE:</p> <p>DETOUR PLAN</p>	<p>PROJECT NO.:</p> <p>17-16</p> <p>DRAWING NO.:</p> <p>HWY-9</p> <p>SHEET NO.:</p> <p>15</p>
REV.	DATE	DESCRIPTION	SHEET NO.																				