



NOTE:
 PROPOSED ADDITIONS ARE ENTIRELY ON THE ROOF OF
 THE EXISTING CHURCH.
 THERE IS NO CHANGE TO THE SITE IN TERMS OF
 DRAINAGE, LANDSCAPING, LIGHTING OR UTILITIES

JOSHUA BRANDFONRENER ARCHITECT
 9 ALDEN PLACE - 4D
 BRONXVILLE, NY 10708
 917.963.1180
 josh@joshbrandf.com

THIS DRAWING IS THE PROPERTY OF JOSHUA BRANDFONRENER ARCHITECT. THE REPRODUCTION OF THIS DRAWING IN ANY MANNER WITHOUT THE WRITTEN PERMISSION OF JOSHUA BRANDFONRENER ARCHITECT IS STRICTLY PROHIBITED. THE ARCHITECT ASSUMES NO LIABILITY FOR ANY DAMAGE TO ANY PROPERTY OR PERSONS ARISING FROM THE USE OF THIS DRAWING. THE ARCHITECT'S LIABILITY IS LIMITED TO THE DESIGN OF THE PROJECT AS SHOWN ON THIS DRAWING. THE ARCHITECT IS NOT RESPONSIBLE FOR ANY OTHER ASPECTS OF THE PROJECT OR FOR ANY OTHER DRAWINGS OR SPECIFICATIONS. THE ARCHITECT'S LIABILITY IS LIMITED TO THE DESIGN OF THE PROJECT AS SHOWN ON THIS DRAWING.

CHRIST CHURCH
NEW ORGAN ENCLOSURES
 254 EAST PUTNAM AVENUE, GREENWICH, CT

FOR SUBMISSION TO
 THE GREENWICH
 PLANNING AND ZONING DEPARTMENT

SITE PLAN

MARCH 18, 2020
A-109

PROPOSED ORGAN
PIPE ENCLOSURE



PROPOSED QUIRE
ENCLOSURE



EXISTING VIEW FROM PUTNAM AVENUE



EXISTING VIEW FROM PUTNAM AVENUE

JOSHUA BRANDFONBRENER ARCHITECT
9 ALDEN PLACE - 4D
BRONXVILLE, NY 10708
917.863.1180
josh@joshbrandfarch.com

THIS DRAWING IS THE PROPERTY OF JOSHUA BRANDFONBRENER ARCHITECT. THE REPRODUCTION OF THIS DRAWING OR THE USE OF THE DRAWING FOR ANY OTHER PROJECT WITHOUT THE WRITTEN APPROVAL OF JOSHUA BRANDFONBRENER ARCHITECT IS STRICTLY PROHIBITED. THIS DRAWING IS NOT TO BE USED FOR ANY OTHER PROJECT WITHOUT THE WRITTEN APPROVAL OF JOSHUA BRANDFONBRENER ARCHITECT.

CHRIST CHURCH
NEW ORGAN ENCLOSURES
254 EAST PUTNAM AVENUE, GREENWICH, CT

FOR SUBMISSION TO
THE GREENWICH
PLANNING AND ZONING DEPARTMENT

STREET
PHOTOS

MARCH 18, 2020

A-107

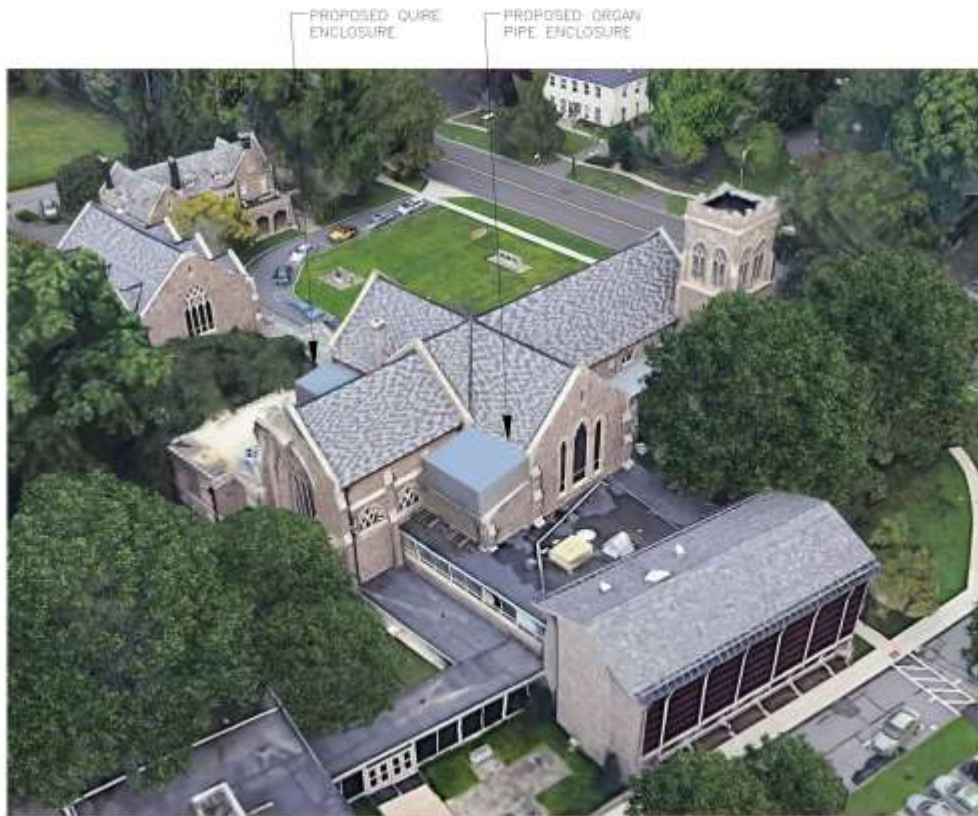

VIEW FROM ABOVE PAVING LOT

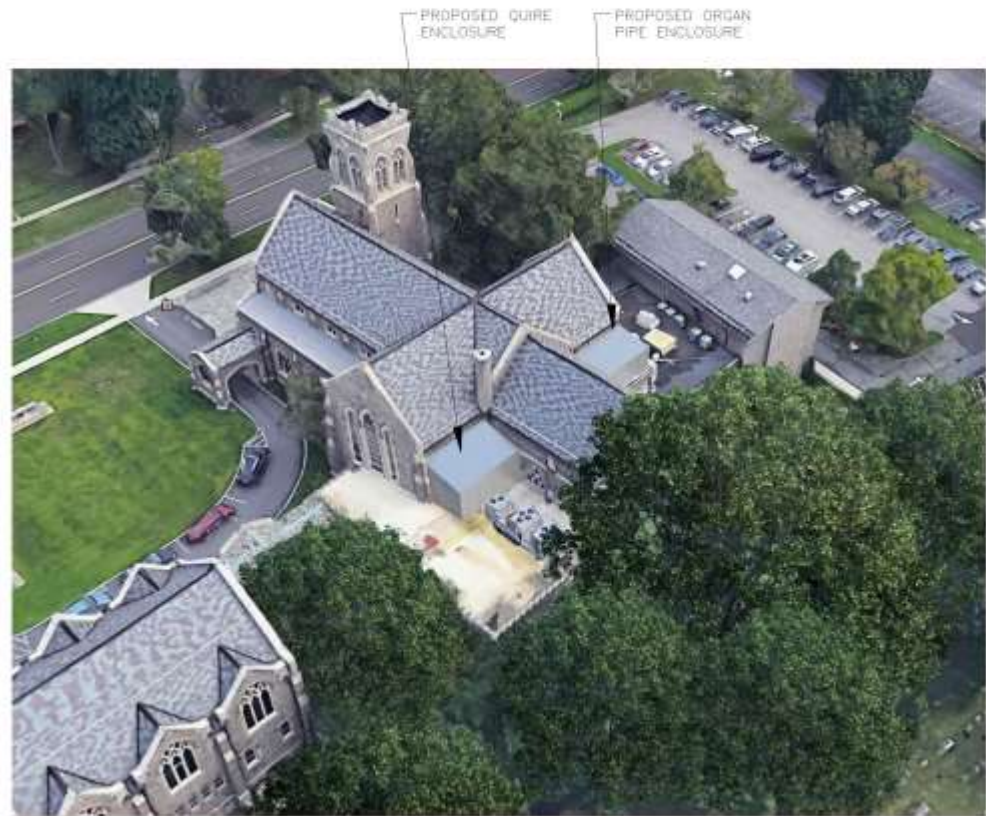

VIEW FROM ABOVE PARISH HOUSE



WEST ELEVATION
1/4" = 1'-0"



JOSHUA BRANDFONBRENER ARCHITECT
 9 ALDEN PLACE - 4D
 BRONXVILLE, NY 10708
 917.963.1180
 josh@joshbrandfarch.com

THIS DRAWING IS THE PROPERTY OF JOSHUA BRANDFONBRENER ARCHITECT. THE REPRODUCTION OF THIS DRAWING OR THE USE OF THE INFORMATION CONTAINED HEREIN FOR ANY OTHER PROJECT WITHOUT THE WRITTEN APPROVAL OF JOSHUA BRANDFONBRENER ARCHITECT IS STRICTLY PROHIBITED. THE ARCHITECT ASSUMES NO LIABILITY FOR ANY DAMAGE TO PERSONS OR PROPERTY CAUSED BY THE USE OF THIS DRAWING.

CHRIST CHURCH
NEW ORGAN ENCLOSURES
 254 EAST PUTNAM AVENUE, GREENWICH, CT

FOR SUBMISSION TO
 THE GREENWICH
 PLANNING AND ZONING DEPARTMENT

WEST
 ELEVATION

MARCH 18, 2020
A-103



2 EAST ELEVATION
1/8" = 1'-0"

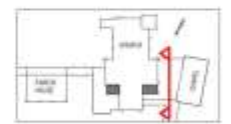

JOSHUA BRANDFONBRENER ARCHITECT
 9 ALDEN PLACE - 4D
 BRONXVILLE, NY 10708
 917.963.1180
 josh@joshbrandfarch.com

THIS DRAWING IS THE PROPERTY OF JOSHUA BRANDFONBRENER ARCHITECT. THE REPRODUCTION OF THIS DRAWING OR THE USE OF THE INFORMATION CONTAINED HEREIN FOR ANY OTHER PROJECT WITHOUT THE WRITTEN APPROVAL OF JOSHUA BRANDFONBRENER ARCHITECT IS STRICTLY PROHIBITED. THE ARCHITECT ASSUMES NO LIABILITY FOR ANY DAMAGE TO PERSONS OR PROPERTY ARISING FROM THE USE OF THIS DRAWING.

CHRIST CHURCH
NEW ORGAN ENCLOSURES
 254 EAST PUTNAM AVENUE, GREENWICH, CT

FOR SUBMISSION TO
 THE GREENWICH
 PLANNING AND ZONING DEPARTMENT

EAST
 ELEVATION

MARCH 18, 2020
A-104



A SECTION THRU ORGAN CHAMBER LOOKING EAST
178" x 7'-0"





SECTION THRU QUIRE ENCLOSEURE LOOKING WEST
 1/8" = 1'-0"



JOSHUA BRANDFONBRENER ARCHITECT
 9 ALDEN PLACE - 4D
 BRONXVILLE, NY 10708
 917.963.1180
 josh@joshbrandfarch.com

THIS DRAWING IS THE PROPERTY OF JOSHUA BRANDFONBRENER ARCHITECT. THE REPRODUCTION OF THIS DRAWING OR THE USE OF THE INFORMATION CONTAINED HEREIN FOR ANY OTHER PROJECT WITHOUT THE WRITTEN APPROVAL OF JOSHUA BRANDFONBRENER ARCHITECT IS STRICTLY PROHIBITED. THE ARCHITECT ASSUMES NO LIABILITY FOR ANY DAMAGE TO PERSONS OR PROPERTY ARISING FROM THE USE OF THIS DRAWING.

CHRIST CHURCH
NEW ORGAN ENCLOSURES
 254 EAST PUTNAM AVENUE, GREENWICH, CT

FOR SUBMISSION TO
 THE GREENWICH
 PLANNING AND ZONING DEPARTMENT

SECTION @
 QUIRE
 ENCLOSEURE

MARCH 18, 2020
A-106